

# X-PLA

## Plasma Air Sterilizer

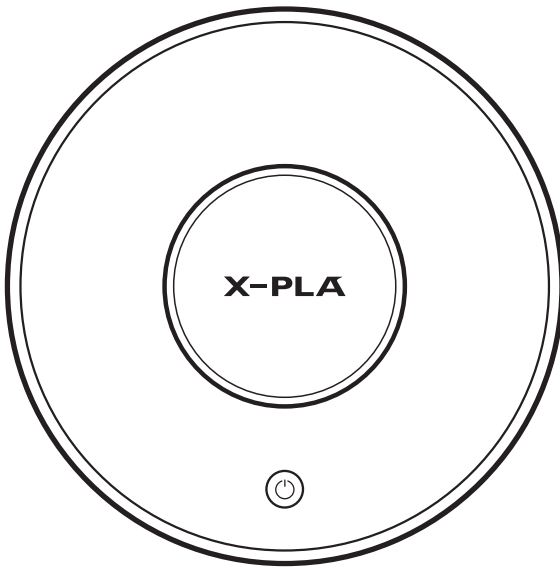

---

### **Warning**

- Read all instructions and cautionary markings in this manual before using the product.
  - The product is packed in the eco-friendly paper packaging box to prevent product impact. Be careful with using the tools (e.g. knife) as it may be damaged when opening the outer box.
-

# PRODUCT PACKAGE

---

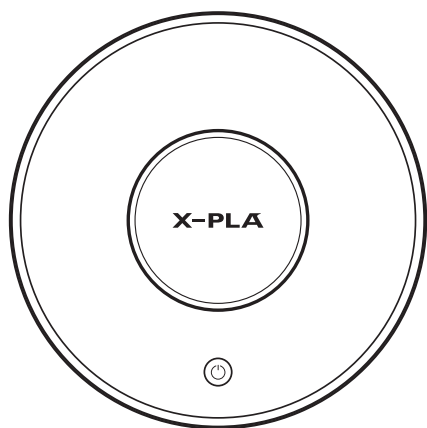

Front view

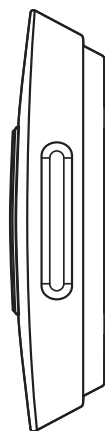

Side view

**X-PLA Body**

---

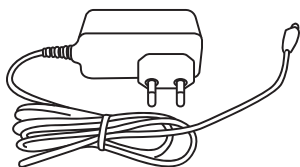

**Adaptor with power cord**  
(18V, 1A)

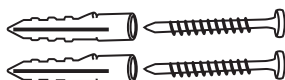

**Screws for Wall Mount**

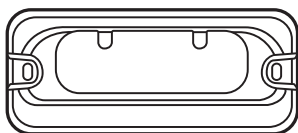

**Mounting Bracket**



**User Manual**

## HOW TO INSTALL (Wall Mount Type)

---

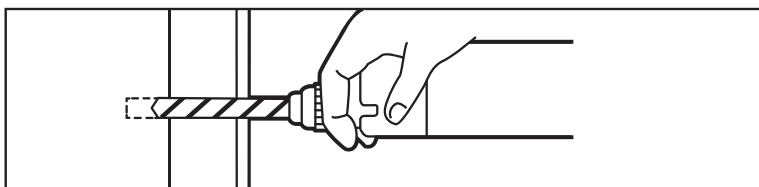

① Drill the 6mm diameter holes 107mm apart at least 30mm deep.

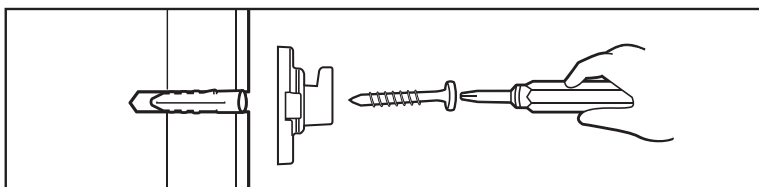

② Screw the mounting bracket to the wall using the screws provided.

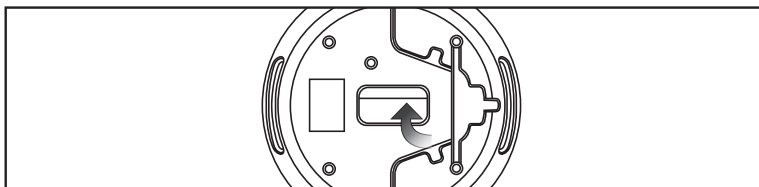

③ Hang the main body on the mounting bracket. (See the arrow.)

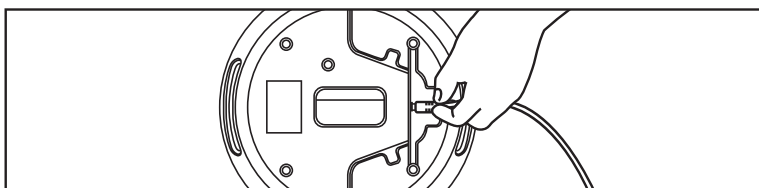

④ Plug the AC adapter into the power connector of the product.

- ⓘ **Warning**
- Do not use in locations exposed to moisture or water.
  - Avoid the place where the children can reach to.
  - Do not touch with wet hands.

## CONTROLS OVERVIEW

---

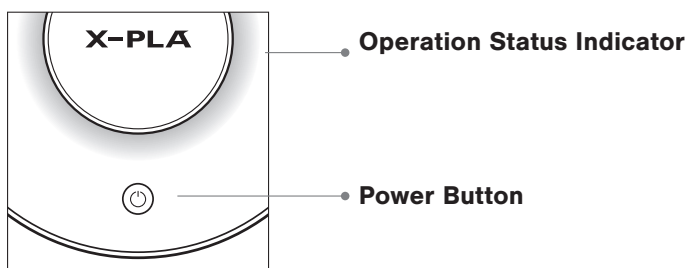

## HOW TO OPERATE

---

### 1. Power On

Press the power button.

### 2. Power Off

During operation, press the power button to stop the operation.



#### NOTE

When the power is on, the operation status indicator is lit to activate plasma.

## HOW TO CLEAN AND MAINTANANCE

---



#### Warning

- Always unplug the product before cleaning.
- Clean after fan is completely stopped.
- Never use alkaline detergent or flammable cleaning agents such as acetone, bleach or alcohol to clean any part of the product.
- Do not disassemble the product.

### 1. Clean the outside of the appliance

- Wipe away dust with a soft cloth soaked in warm water from the surface of the product.

### 2. How to store when the product is not used for long term

- Avoid the place exposed to high humidity.
- Store the product with silica gel.

## IMPORTANT SAFETY INSTRUCTION

---

- This page is designed to ensure user safety and the prevention of damage to the product.
- Read this user manual carefully before you use the product, and ensure the product is used properly.

### **DANGER — To reduce the risk of serious injury or death**

- Do not use in locations exposed to moisture or water.
- Do not install the product near a heating device or under the direct sunlight.
- Avoid the place with the possible gas leakage.
- Do not touch the product and power plug with wet hands.
- Check if the voltage indicated on the appliance corresponds to the local power voltage before you connect the product.
- Insert a power plug into the wall outlet with placing the wire downward.
- When removing the power plug, always hold the plug and never pull by the cord.
- Do not bend cord badly, and it may damage the cord.
- Never allow any liquid to enter the product.
- Do not operate the product with a damaged cord and plug. Do not disassemble, modify, and repair the product. All other repairs or exchanges should be completed by a qualified technician, manufacturer or distributor to avoid any risk.
  - Contact Customer Service. See the information on the last page of this manual.
- The product should not be used by person (including children) with reduced physical, sensory or mental capacities or lack of experience and knowledge, unless they are supervised or have been given instructions beforehand concerning use of the product by person responsible for their safety. Children must not play with or on the product.
- Do not run cord/adaptor under carpeting and heavy objects including furniture or appliances, and cover cord/adaptor with throw rugs, runners, or similar coverings.
- Arrange the cord away from traffic areas where it can be tripped over.

### **WARNING — To reduce the risks of, burns, fire, electric shock, or injury to persons and product damage**

- Set up the product on flat, stable ground.
- Do not unplug while the product is in operation.
- Always unplug the product when not in use.
- Leave enough space between the product and any other products.

- Avoid any mechanical or physical shock to the product and power adaptor.
- Always unplug the product before cleaning or carrying out other maintenance.
- If you need to move the product, disconnect the product from the power supply first.
- Do not reach for the product that has fallen into water. Unplug it immediately and contact service center.
- Do not insert fingers or foreign objects (e.g. needles, wooden stick, chopsticks, etc.) into the intake or air outlet to prevent physical injury or malfunctioning of the product.
- Do not place anything around/on to the product. Never block the air intake/outlet.
- Do not use the product close to flammable objects or products (curtains, aerosols, solvents, etc.)
- Do not splay any flammable materials such as insecticides or fragrance around/to the product.
- Do not use the product with tilting or turning it upside down.
- The product is only intended for indoor use under normal operating conditions.

## TROUBLESHOOTING

---

### PROBLEM

### POSSIBLE CAUSE / SOLUTION

Product does not operate.

- Ensure the power adapter is connected.
- Ensure the power jack is disconnected from the product.

The “buzzing” sound continues while the product is operating.

- The sound is generated in normal when the plasma mode is activated.

The “whirring” sound continues while the product is operating.

- This is the sound of a fan running.
- When the product stop running, the fan may make a whirring sound as it slows down and stops.

The product produces a strange smell.

- When the plasma mode is operated, a characteristic odor may be emitted due to the sterilization effect. The smell is harmless to the body and it is normal to use as it is.
-

## WARRANTY

---



### Warranty and coverage : 1-year limited warranty

- COBI PLATEC provides the limited warranty for individuals or organizations purchasing the device from COBI PLATEC or an authorized distributor.
- COBI PLATEC warrants material and manufacturing defects during normal use for one year from the date of original purchase. (“Warranty Period”) If the device is returned to COBI PLATEC during the warranty period, COBI PLATEC may repair the device, replace it with a fully refurbished one, or refund the purchase price. (Excluding discount or promotional code purchases) If the warranty period has expired or does not apply to the scope of warranty and restrictions, COBI PLATEC may return the device back to the user.

## SPECIFICATION

---

<b>Item</b>	Plasma Air Sterilizer
<b>Purifying Techniques</b>	Atmospheric-Pressure Plasma
<b>Model</b>	CPT-XP100
<b>Gross Weight</b>	1.3kg (2.8lb.)
<b>Power Supply</b>	DC18V/1A, 9W
<b>Dimensions</b>	Ø320x82mm (Ø12.6x3.2in.)
<b>Where to Install</b>	Indoor

\* The product design and specification is subject to be changed without prior notice.

## CUSTOMER SERVICE

---

Thank you for purchasing a Plasma Air Sterilizer X-PLA. Visit COBI PLATEC website for special promotion, online help, general tips and useful information about Plasma Air Sterilizer X-PLA.



### Website

<http://eng.cobiplatec.com>



### Address

[Seoul Office]  
2F, 131, Yangjaecheon-ro, Seocho-gu, Seoul, KOREA (Zip code: 06747)

[Factory/R&D]  
47, Deurimsandan 2-ro, Cheongbuk-myeon, Pyeongtaek-si, Gyeonggi-do,  
Republic of Korea (Zip code: 17796)

# X-PLA

Plasma Air Sterilizer



**Website**

<http://eng.cobiplatec.com>



**Address**

[Seoul Office]

2F, 131, Yangjaecheon-ro, Seocho-gu, Seoul, KOREA (Zip code: 06747)

[Factory/R&D]

47, Deurimsandan 2-ro, Cheongbuk-myeon, Pyeongtaek-si, Gyeonggi-do,  
Republic of Korea (Zip code: 17796)

---